

»
**GETTING A HANDLE
ON SCHOOL
SECURITY**

School Security & Safety Seminar
for Bergen County ASBO

JANUARY 17, 2018



**SOLUTIONS
ARCHITECTURE**

FRANK A. MESSINEO • AIA



GETTING A HANDLE ON SCHOOL DISTRICT SECURITY

ARCHITECT
FRANK MESSINEO, AIA
SOLUTIONS ARCHITECTURE

SECURITY EXPERT
CARL MITTLEHAMMER
SECURITY SPECIALIST

U.S. DEPT. OF HOMELAND
SECURITY (TSA)
CAROL RANDOLPH
TRANSPORTATION SECURITY INSPECTOR, SURFACE

LAW ENFORCEMENT
CHIEF GARY MANNA
FAIRFIELD POLICE DEPARTMENT



GETTING A HANDLE ON SCHOOL **SECURITY**

.....
GOALS OF THIS PRESENTATION:

- » **WHY ARE WE HERE?**
- » **REACTIONS TO CRISIS**
- » **DEBUNK MYTHS**
- » **WHAT CAN WE DO?**
- » **FACILITIES ASSESSMENTS**
- » **BEHAVIORAL SIGNALS**



WHY ARE WE HERE?



» DEADLY TRAGEDIES

NOV. 29, 2015

3 dead; 9 injured | Colorado Springs, Colo.



(David Zalutowski / Associated Press)

JUN. 18, 2015

9 dead: Charleston, S.C.



Jessica Oliver leaves flowers on a memorial in front of the Emanuel African Methodist Episcopal Church. (Getty Images)

DEC. 2, 2015

DEVELOPING: 14 dead, 21 wounded | San Bernardino, Calif.



(Marcus Yano/Los Angeles Times)

JUL. 16, 2015

5 dead, 3 wounded: Chattanooga, Tenn.

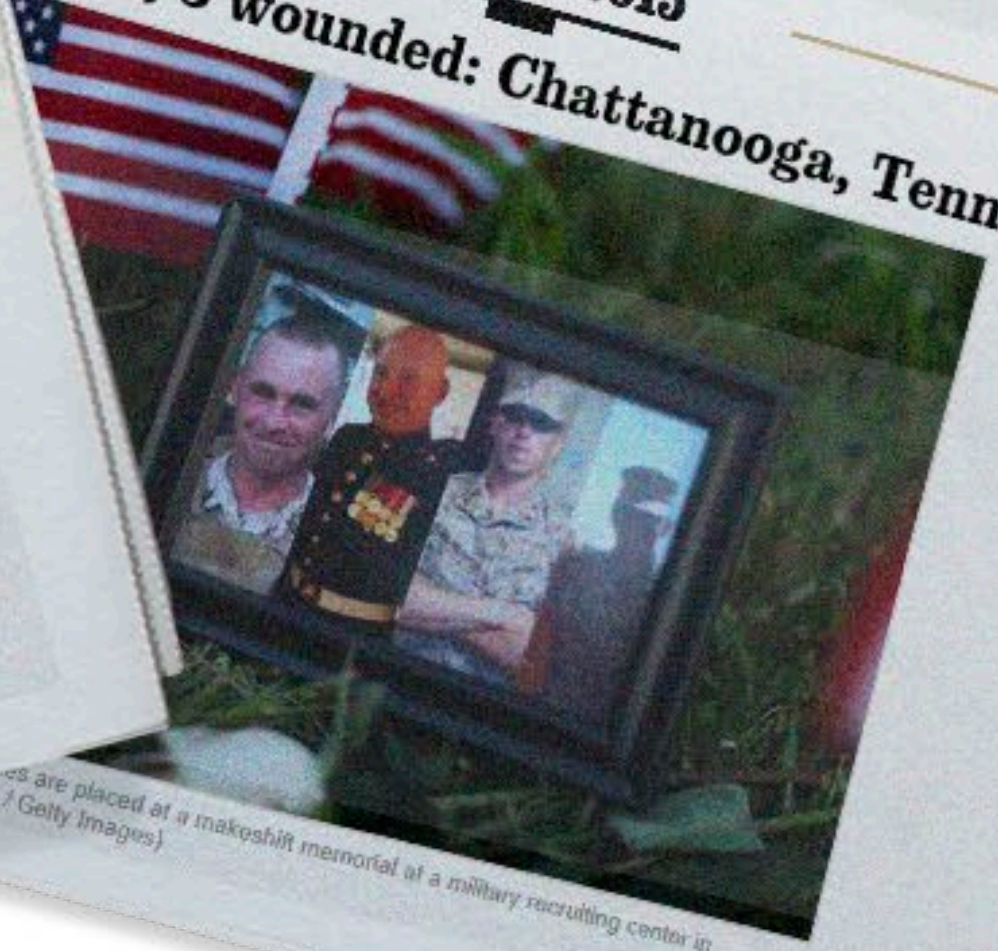

Photos are placed at a makeshift memorial at a military recruiting center in Chattanooga. (Getty Images)

OCT. 1, 2015

injured: Roseburg, Ore.

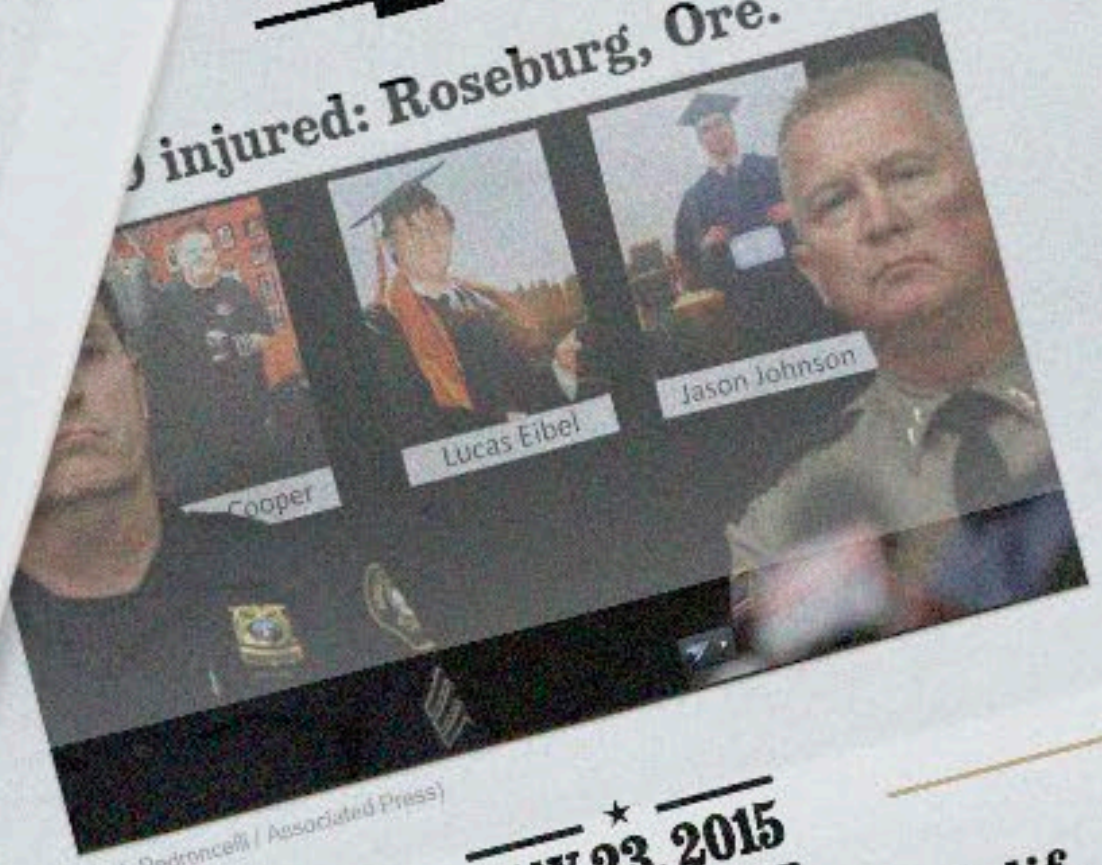

(Rich Pedroncelli / Associated Press)

MAY 23, 2015

6 dead, 7 wounded: Isla Vista, Calif.



A memorial in People's Park in remembrance of those who were killed and injured on May 23, 2014. (Genaro Molina / Los Angeles Times)



NEED TO UPDATE THESE NEWS WITH CURRENT

» NOT THE FIRST...OR THE LAST



DECADE	# OF MASS SHOOTINGS
1840's	1
1850's	3
1860's	6
1870's	7
1880's	11
1890's	9
1900's	15

DECADE	# OF MASS SHOOTINGS
1910's	9
1920's	10
1930's	9
1940's	8
1950's	17
1960's	18

DECADE	# OF MASS SHOOTINGS
1970's	29
1980's	39
1990's	61
2000's	63
2010-2014	90
2015-2016	57

List of U.S. School shootings from the 1800's to today



ACTIVE SHOOTER



» ACTIVE SHOOTER



An active shooter is an individual actively engaged in killing or attempting to kill people in a populated area. In most case, active shooters, use firearms and there is no pattern or method...unpredictable

An event becomes a mass shooting once the number of injured and/or dead reaches four (excluding the shooter)

Recent active shooter incidents have underscored the need for a coordinated response by law enforcement and others to save lives.

» ACTIVE SHOOTER

INCIDENTS BY LOCATION:

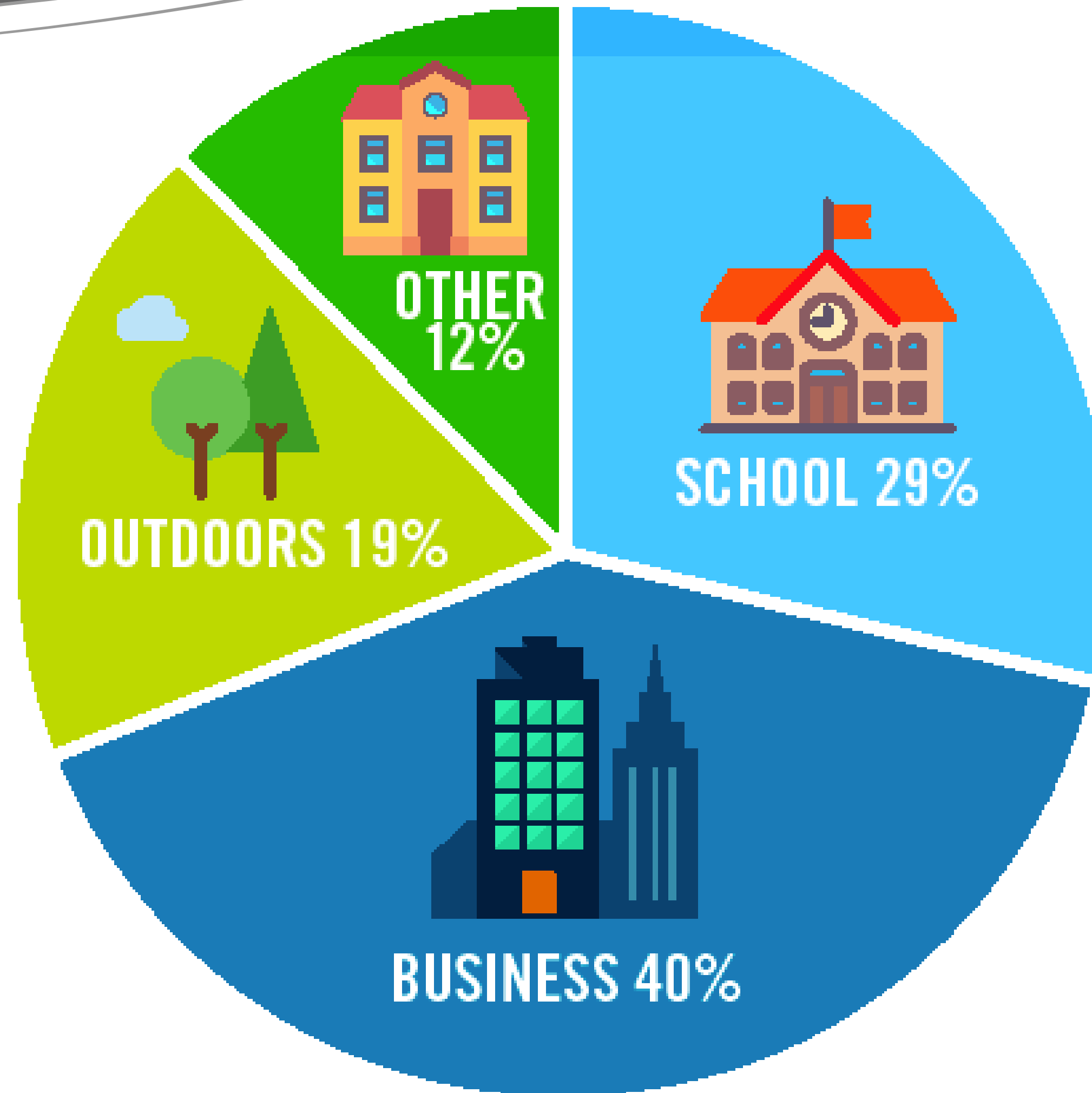

» RECENT INCIDENT STATISTICS



- » **AS OF NOVEMBER 2018** -there had been **307** mass shootings across the country that includes schools, nightclubs, bars etc. *(Business Insider)*
- » **AS OF THE END OF 2018** - there were **365** mass shootings. **1 per day.** (want to add a scrolling table of mass shootings here - file in folder)
- » **ALREADY IN 2019** - there have been **6** mass shootings *(none school related)*

» WHY SCHOOLS?



GIVEN THE...

- » Sheer size of the country's school system
- » Predictability of school schedules and holidays
- » Attractiveness as a "soft target"

WE ARE VULNERABLE...

- » Open access
- » Large concentrations of students outside
- » Limited security at after-school events
- » Limited security of school buses

» NOTABLE SCHOOL INCIDENTS (MASS SHOOTINGS)



- » **May 2018** - Santa Fe, Texas - **17-year-old student**, armed with a shotgun & handgun, inside the school *(10 dead, 13 injured)*
- » **Feb 2018** - Parkland, Florida - **19-year-old former student**, armed with a rifle, outside the school, after activating a fire alarm *(17 dead, 17 injured)*
- » **2012** - Newtown, Connecticut - **20-year-old**, four guns, inside the school, after shooting through a side-lite

» RECENT INCIDENT STATISTICS



» **IN APRIL OF 2018** - In light of the incident in Parkland SA held a roundtable event to discuss School Security. Since that day there have been have **51** school shootings across the country. *(Wiki)*

April May June August Sept October Nov December

4 7 3 11 7 11 7 1

****all but two (2) of these acts were perpetrated by Students or Former Students**

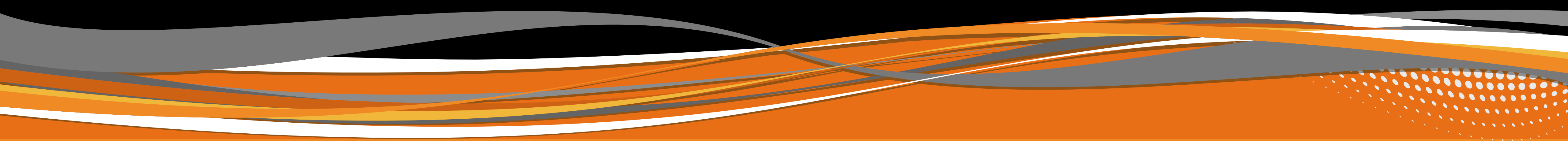

REACTIONS TO CRISIS



» STUDENTS & PARENTS REACTIONS



MANY ARE SCARED...

Some parents want to know districts are going to guarantee the safety of their child 100% of the time

Students want to know the same...and some have even turned to bringing in weapons to defend themselves

SOME ARE NOT...

..and trust that the school system is doing everything possible to keep their children as safe

» SCHOOL DISTRICT REACTIONS



- » Visitor/Staff/Student Entry Procedures & Construction
- » Evening security/access control for after school & public events
- » Visible badges/lanyards for faculty / student / visitors
- » Strict Dress code/uniform - Clear / Kevlar Backbacks
- » Bullet Resistant' Film/Glass
- » Whole building camera systems
- » Electronic Door Hardware / Panic Buttons

» SCHOOL DISTRICT REACTIONS

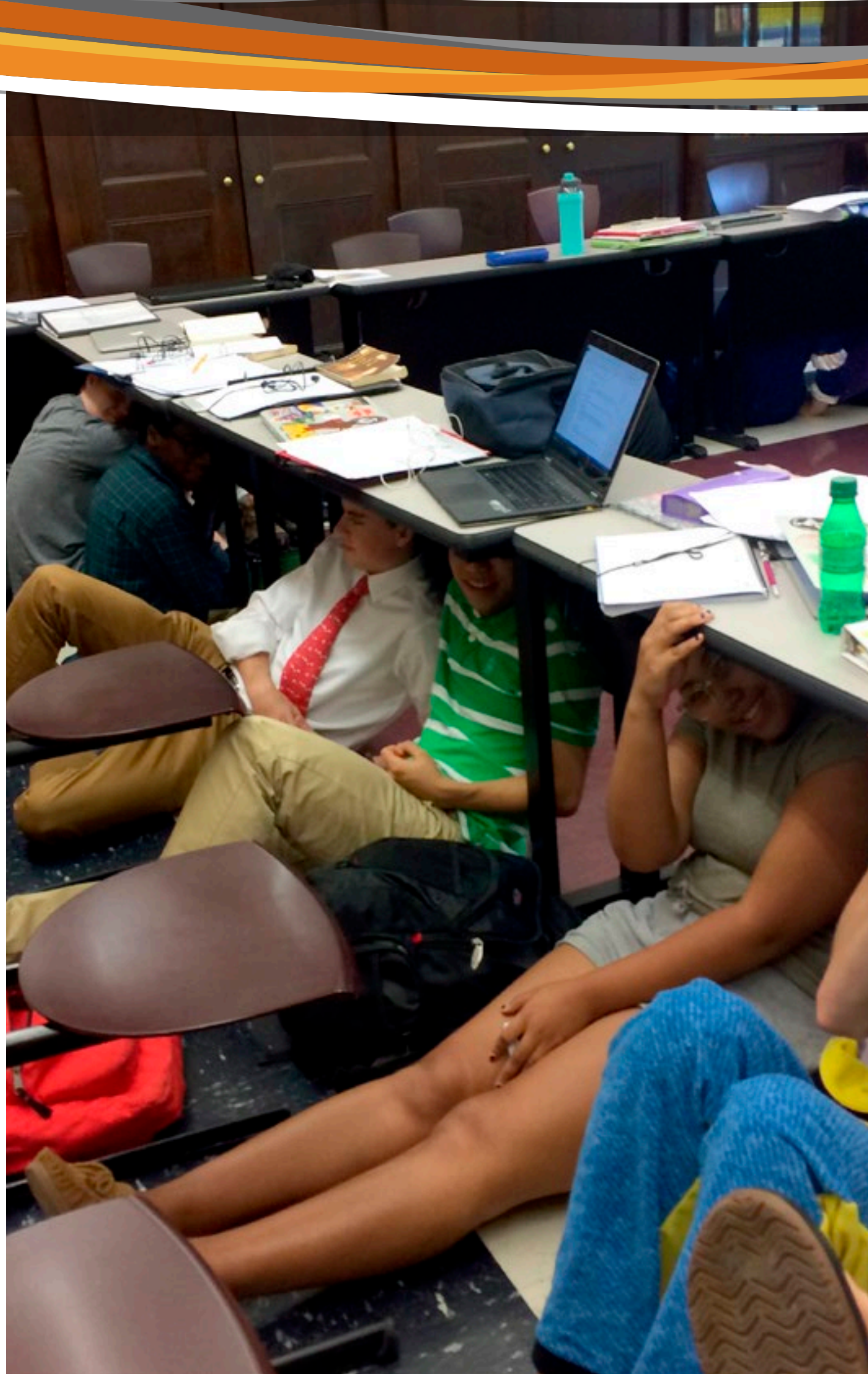

- » Gating off areas of the building
- » Parking lot/campus monitoring
- » School crisis plan and preparedness training
- » See something, say something programs
- » Student crisis apps – “Safe Utah” / tip lines
- » Blue notifier lights outside schools
- » Shelter-in-place units in classrooms

» SCHOOL DISTRICT REACTIONS



- » Armed Guards / School Resource Officers
(SRO - Class III officers)
- » Police Presence» Arming Teachers / Administrators?
- » Metal Detectors
- » Door Jammers
- » Smoke cannons in corridors

Complaint Review: Peter Fabian - ACE Security Laminates

Related Reports

[World ACE Peter Fabian seems like a criminal....! Ottawa Ontario](#)

[Ace Security Laminates Con you out of tens of Thousands of dollars!! Can not be trusted!! Ottawa Ontario](#)

[Ace praid cards, NETSPEND, METABANK PREPAID CARDS Opened accounts with my stolen ID to cash 300,000.00 El Paso.](#)

- Submitted: Mon, July 14, 2008
- Updated: Mon, July 14, 2008
- Reported By: — Owensboro Kentucky

Peter Fabian - ACE Security Laminates
200 Isebella
Ottawa, Ontario
U.S.A.

- Phone:
- Web:
- Category: Questionable Activities

by consumers, for consumers...

Ripoff Report

Don't let them get away with it!® Let the truth be known!™

Complaint Board | NATIONAL CONSUMER COMPLAINT FORUM

I was fooled by Peter Fabian and his people at ACE and bought a dealership from AKA ACE Security Laminates / World ACE / ACE in Canada. I am now broke because of the monster men con-artists at large. They sold me fake product from an Indian company and then some from a company in the Middle east. The product performs like window tint from 3M no good. It cannot stop from glass breaking or stop bullets as they told me. I have tried to get my money back, but ACE does not take my calls or emails. I lost \$100,000.00 US dollars and now cannot get it back. I am suing ACE and Peter Fabian through my attorneys. I beg anyone that has had dealings with this corrupt Man Peter Fabian and his company to ban together in an international lawsuit for poor and unethical business practices. if your thinking of dealing with this person DO NOT, you will only be taken advantage of and scammed like I was. I know only now through others that he is under legal investigation and owes millions of dollars to many people and Governments. Peter Fabian is the DEVIL HIMSELF...DO NOT DO BUSINESS WITH HIM OR HIS COMPANY

» 'BULLET PROOF' FILM!!





DEBUNK THE MYTHS



» "BULLET PROOF" = MYTH

THE TRUTH ABOUT 'BULLET PROOF / RESISTANT' FILM There is no such thing!

Home 3M Window Films ▾ Commercial Window Tinting ▾ Graphics Installation ▾ About ▾ 3M Dealer Locator ▾ News

Bulletproof Film – There is no such product!

You are here: [Home](#) › [Bulletproof Film - There is no such product!](#)

There are NO "ballistic window films in the market today that are bulletproof. None. Yet, some companies will claim otherwise. They are being misleading and this could prove deadly. What are the facts? There are some security film + laminated or polycarbonate glazing combinations that will provide a level of ballistic resistance. Security film + 'normal' glass will not stop bullets. Never.

» BULLET RESISTANCE ... ???

WHAT IS BULLET-RESISTANT GLASS?

- » Bullet resistant glass is actually one of several types of bullet-resistant thermoplastic, sometimes laminated in layers that include traditional tempered glass. It is a little known fact that in most cases there is no actual “glass” involved.





FACTS ABOUT SAFETY / SECURITY FILM

Excellent product for Impact Protection...

- » Buys time for first responders to arrive
- » Prevents glass from shattering during break-ins
- » Reduces flying glass shards during bomb blasts
- » It should be always be applied to the interior
- » There are several different thicknesses available:
 - 8 mil through 21 mil (a mil is 1/1000th of an inch)
 - Costs range from \$7/sf to \$40/sf
- » The thicker it is, the more time and protection...



FACTS ABOUT SAFETY / SECURITY FILM

Did you know adding film to your exterior windows can VOID your insulated glass warranties?

- » A layer of film increases heat build up in the cavity
- » Standard annealed glass, low-E or tinted glass will be affected the most
- » Tempered Glass is heat treated and is more likely to handle the increased temperature
- » Depends on the type of glazing and manufacturer

» MAKING INFORMED DECISIONS

1 Bulletproof Acrylic

The most common glass: a single piece of 1-1/4" to 1-3/8" solid plastic sheet, used mostly indoors.

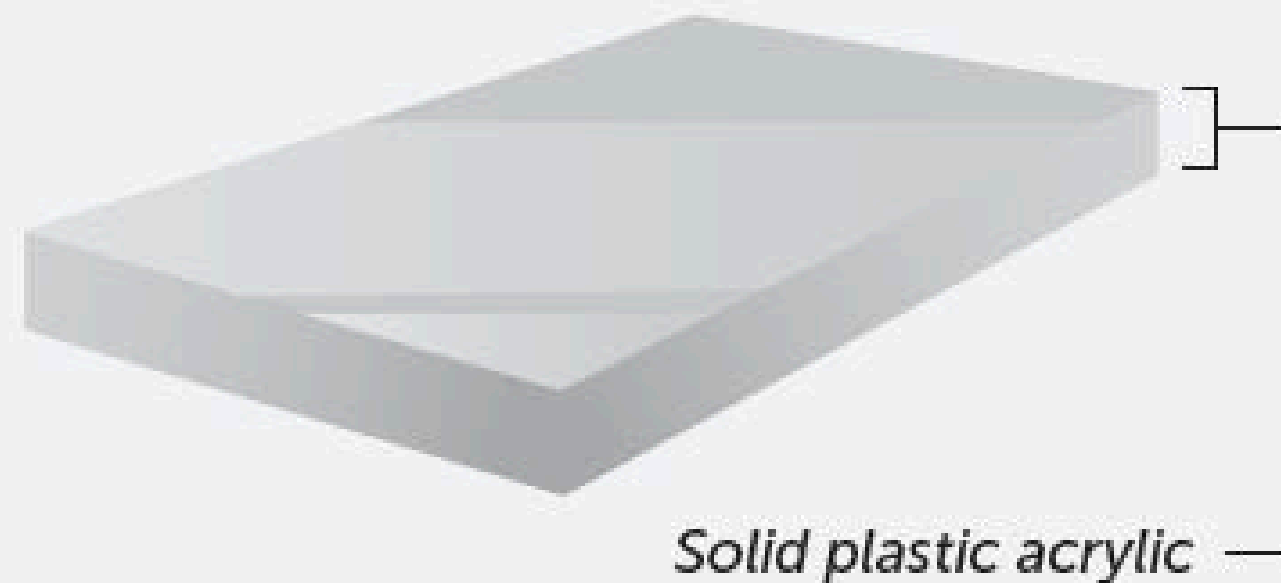

Avg Weight

7.7 lbs
per sq ft

Resistance Level

1-2

2 Laminated Polycarbonate

This glass provides excellent optical clarity and typically weighs less than other materials.

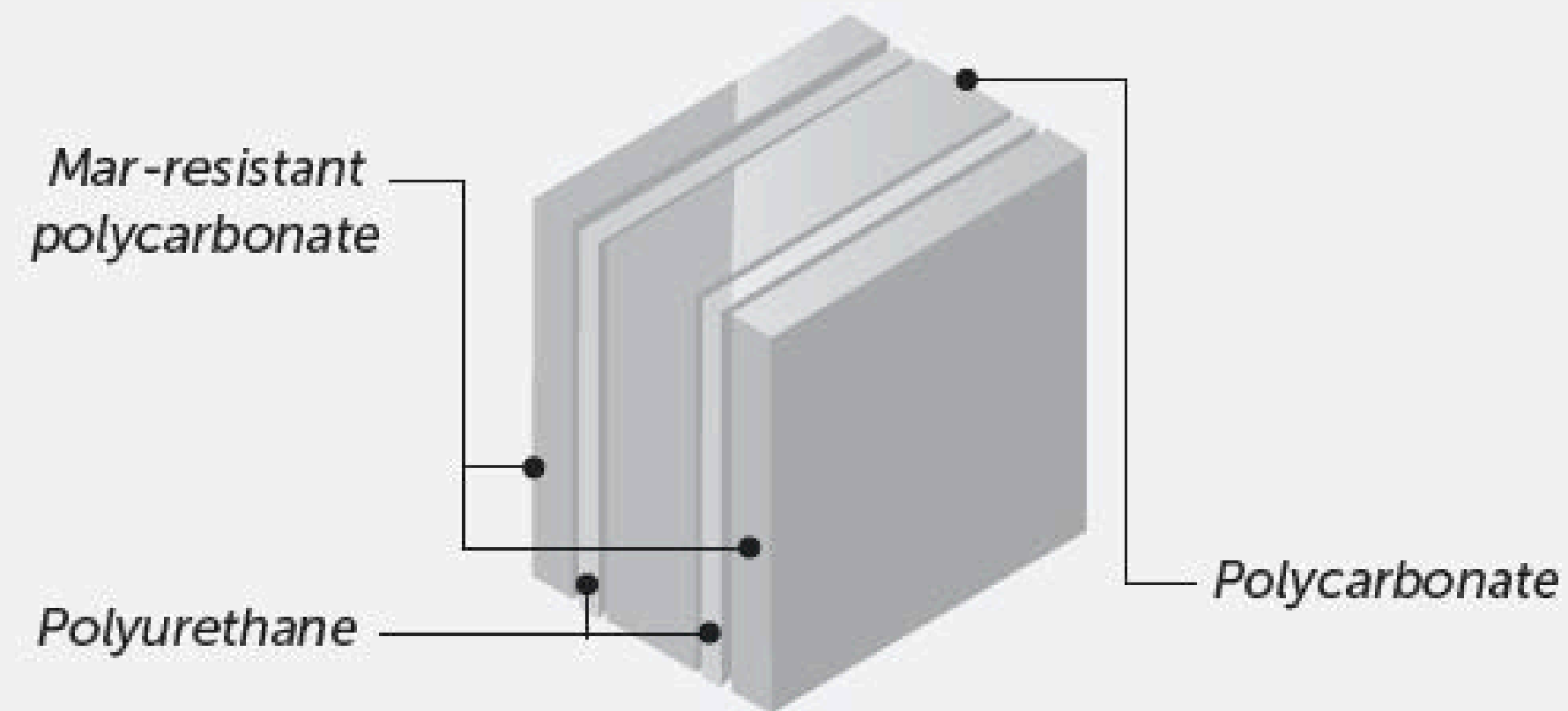

Avg Weight

4.6 lbs
per sq ft

Resistance Level

1-3

3 Glass Clad Polycarbonate

Its thick layers make the highest-rated levels of bullet resistance obtainable. A great choice for exterior use.

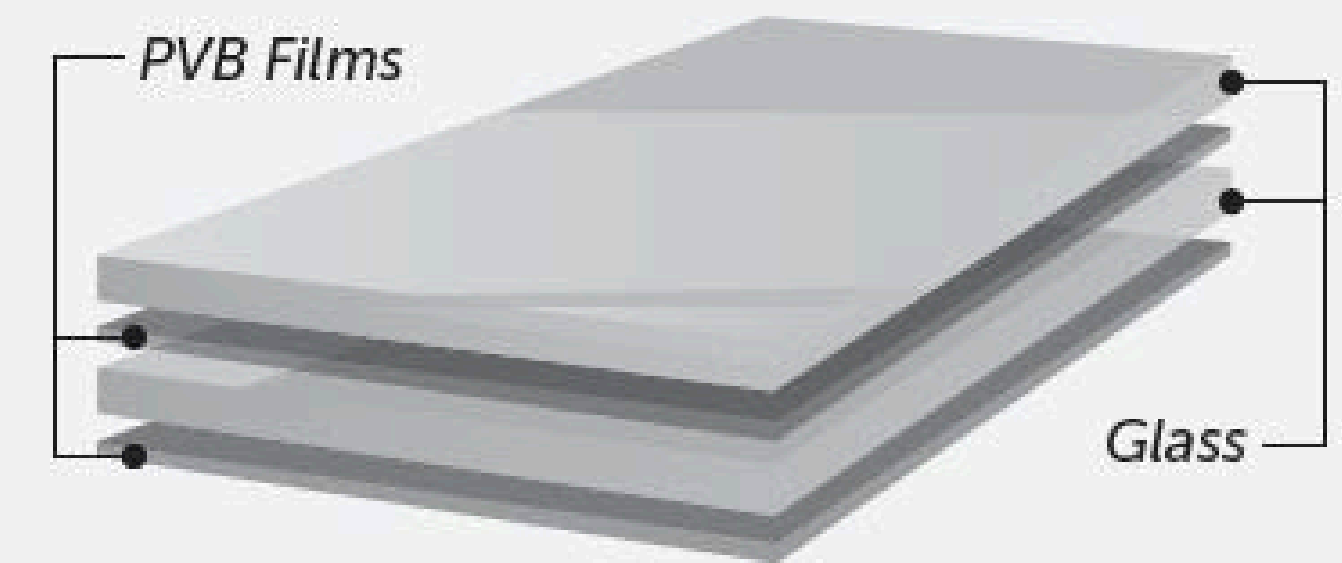

Avg Weight

8.9 lbs
per sq ft

Resistance Level

1-8

» MAKING INFORMED DECISIONS

The 8 Levels of Resistance

Each level of glass has been tested and found effective at stopping certain types of projectiles, ones most typically employed during an armed robbery.

Ammunition	# of Shots	Level
9mm Pistol	3	L1:
.357 Magnum	3	L2:
.44 Magnum	3	L3:
.30-06 Hunting Rifle	1	L4:
AK-47 Assault Rifle	1	L5:
Uzi Submachine Gun	5	L6:
M16 Assault Rifle	5	L7:
AK-47 Assault Rifle	5	L8:

Where is Each Level Most Commonly Found?

- Level 1:** Typically used in gas stations, retail applications, pharmacies, banks, credit unions, gold buyers, pawn shops, & check cashiers.
- Level 2:** Often found in large corporate banks & financial institutions.
- Level 3:** Common for utilities, police stations, & government facilities.
- Level 4 & up:** Government and military uses.

» MAKING INFORMED DECISIONS



IN A PERFECT WORLD...

Without concern for budget, changing out glass is the most secure option where feasible

- » For interior glass, in new or existing doors or frames:
 - 1/4" laminated glass starting at \$30 sf
 - 20/45/90 min ratings available from \$50 to \$125 sf
 - Thicknesses all the way up to 2-1/8" are available
- » For exterior glass, in new or existing doors or frames:
 - 1" insulated glass starting at \$50 sf

**Costs shown are for material only*

LEVEL 3 TRANSACTION WINDOWS

Many administrative staff are concerned for their safety, because they are on the front line...

- » **Bullet resistance can be achieved in certain levels and applications without breaking the bank.**
- » **Transactions windows, commonly used in secure entrances, are customarily made at level 3**
- » **A typical unit costs roughly \$3,000 to \$5,000 for material, delivery plus installation**

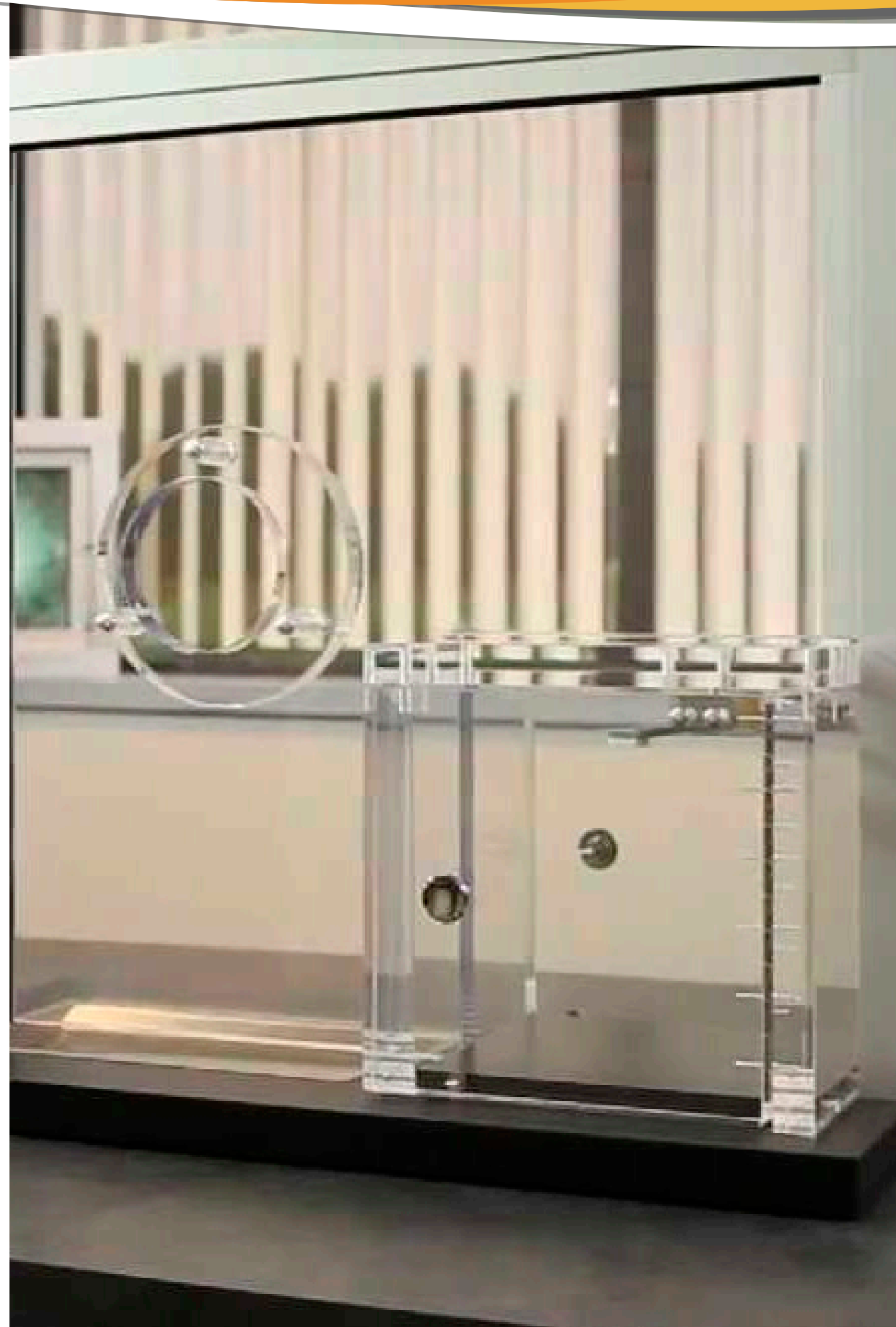



DOORS AND FRAMING AT ENTRANCES

Studies indicate that once an assailant's plan to gain entry is foiled, it is likely they will give up entirely...

- » Ballistic framing is designed to accept standard or bullet resistant glazing in varying thicknesses (lvs 1-8)
- » Hollow metal door and frame, available in Level 3 (14 ga. frame, 16 ga. door – roughly \$4,000 material only)
- » Hollow metal frame and solid wood door, available in Level 3 (roughly \$10,000 material only)

For reference, this is approx. 10x the material cost for a standard metal frame/wood door assembly

THE SURROUNDING CONSTRUCTION

We need to be mindful of the entire composition of openings and walls...

- » Bullet resistant Fiberglass panels (made with DuPont Kevlar) offered in many levels can be used behind drywall or cabinetry - Cost roughly \$14/sf for material
- » Also available with laminate or aluminum finish when trying to retrofit an existing area when there isn't the ability to finish with drywall
- » Is Masonry bullet proof? It really depends on the construction - width, solid filled, material...



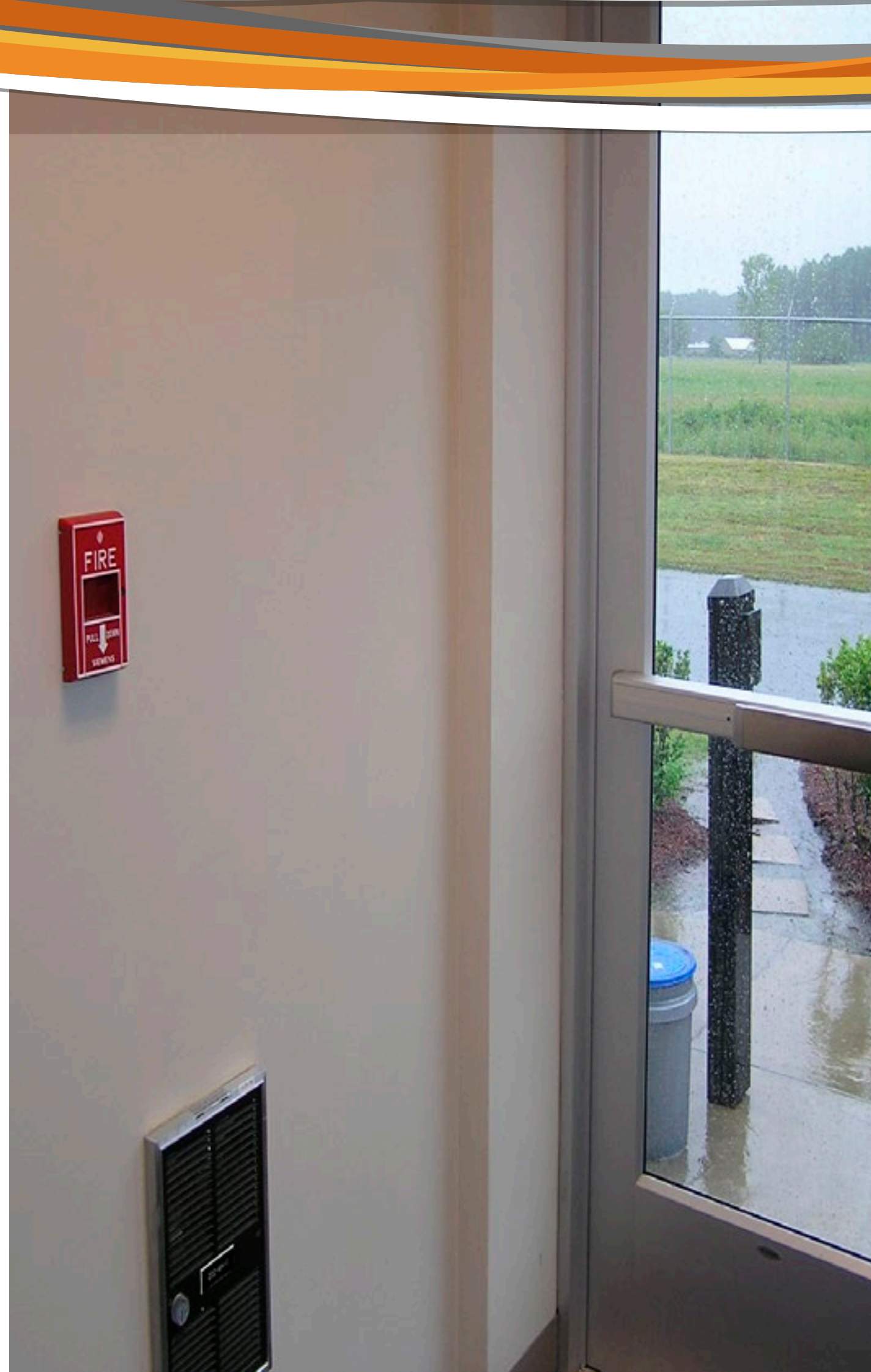

SECURE VESTIBULES AND FIRE ALARM

NFPA code requires a pull station within 60" of an exit door, which would have them located within the vestibule.

- » However, code officials and local law enforcement are working together to allow pull stations be located within 60" of the interior door of the vestibule.
 - This will prevent unwanted visitors from pulling the fire alarm when they have not been admitted to the building.



MORE CONSIDERATIONS – ARE THEY THE RIGHT ANSWER?

Metal Detectors

- » Initial and replacement/maintenance costs
- » Costs for personnel to operate them and for training for staff
- » If ALL students use only one entry? How long will that take?
- » Staffing during after school events
- » Will all employees & parents be subject to metal detector screening?
- » If metal detector is alerted what next steps are taken (i.e. wandling)?



MORE CONSIDERATIONS THAT MAY OR MAY NOT BE THE RIGHT ANSWER...

Armed / Unarmed Guards

» School Resource Officers (SROs)

- Armed
- 40 hour training i.e. education law, working with students

» Class III Officers

- Retired Police Officers (25 years exp. min.)
- Full uniformed police authority on school grounds
- Armed
- SRO Training

» Unarmed School Security Guards

MORE CONSIDERATIONS THAT MAY OR MAY NOT BE THE RIGHT ANSWER...

Classroom Door Hardware

» Per N.J.S.18A:41-1

'shall require all teachers of all schools...to keep all doors and exits of their respective rooms and buildings unlocked during the school hours, except during an emergency lock-down or an emergency lock-down drill.'

» Keyed Intruder Locks

» Thumb Turn Locks

» Door Jammers

» Electronic Strikes - Panic Button

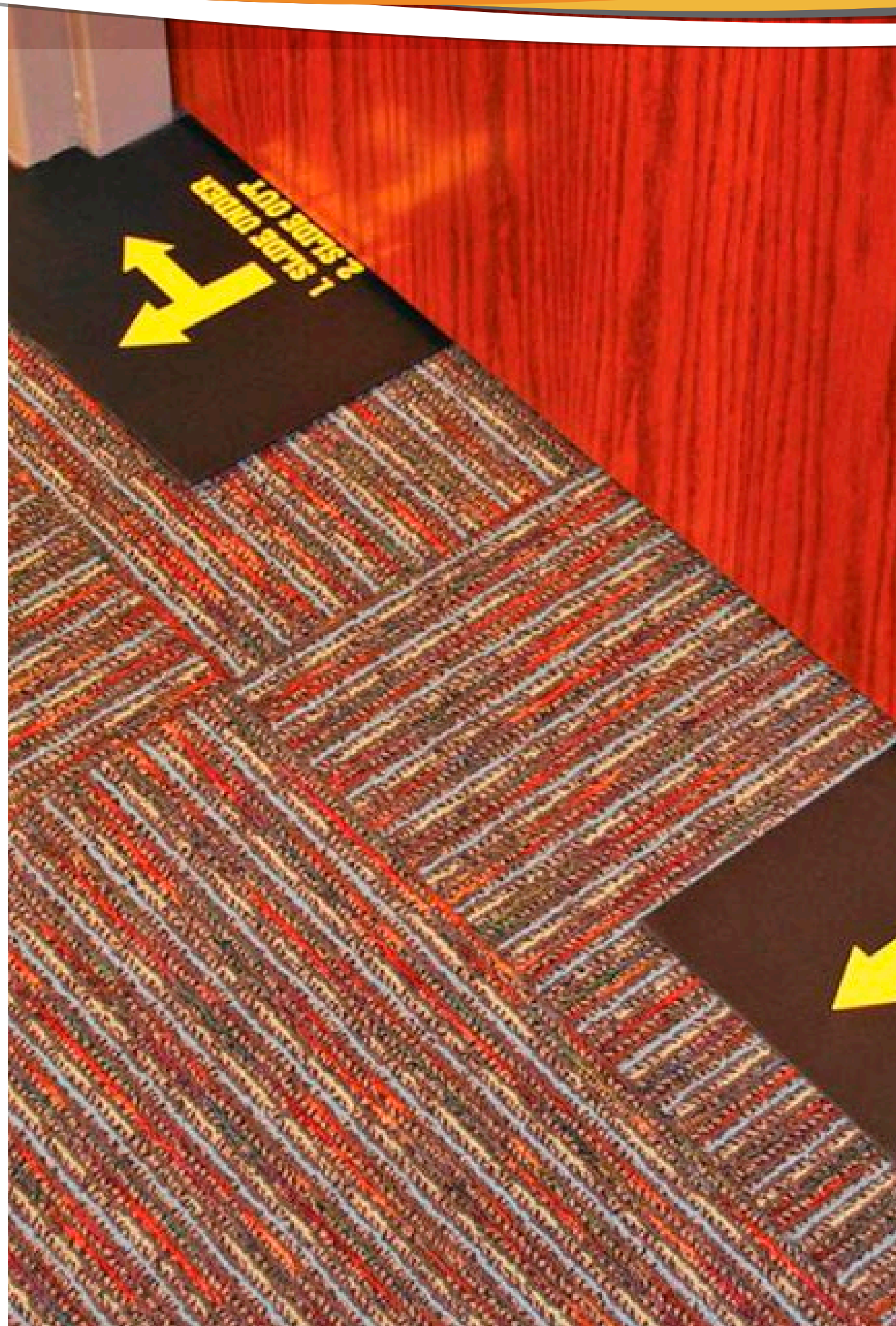



WHAT CAN WE DO?

‘DON’T BELIEVE EVERYTHING YOU HEAR!’



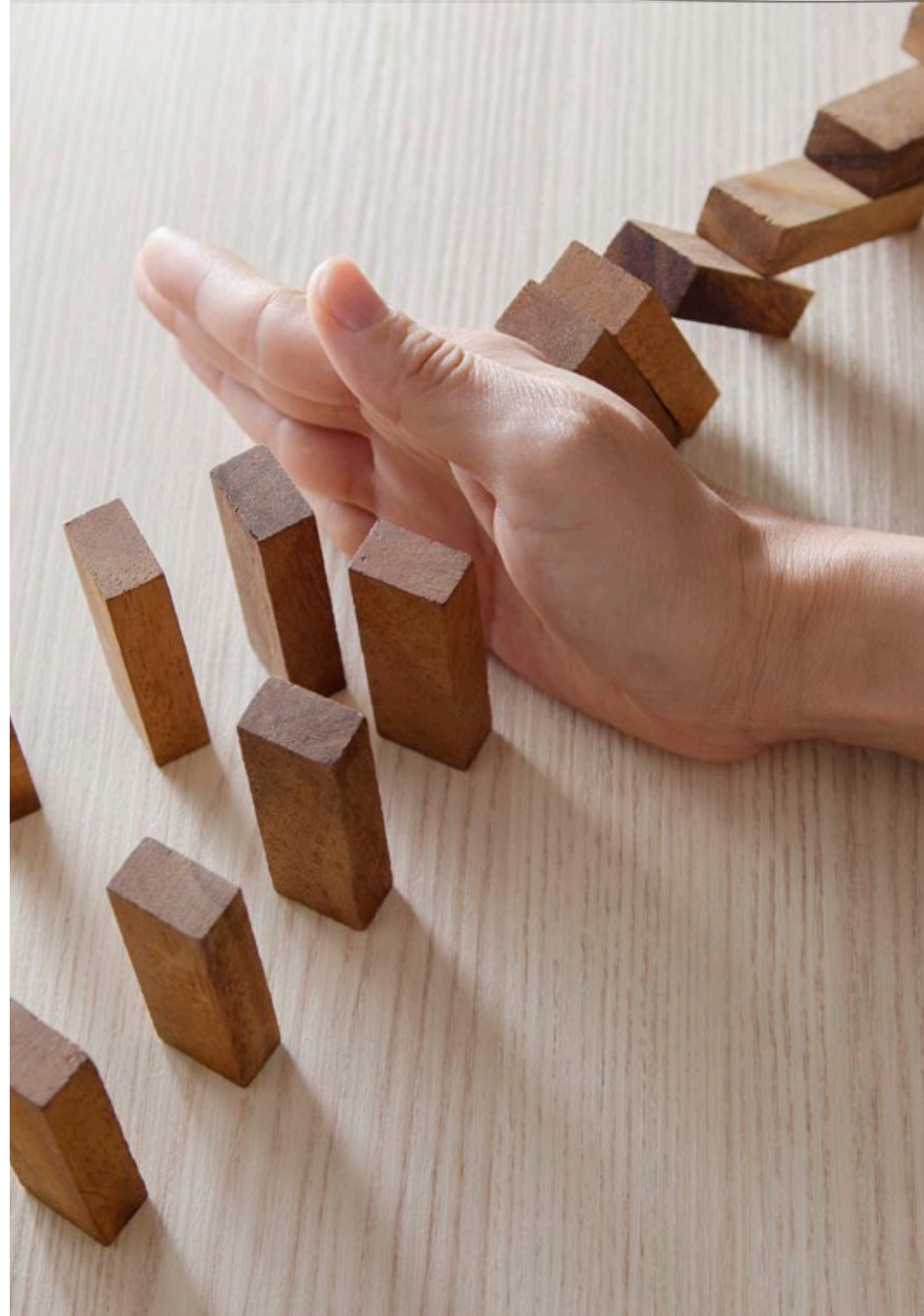

TAKE THE TIME TO EVALUATE / IMPLEMENT

- » What are reasonable and sustainable security measures that will last far beyond this immediate crisis phase we are in...
- » There is always a heightened school security concerns immediately following any school shooting.
- » We must remember that school security has **ALWAYS** been at the forefront of district conversations.



PREVENTION: FACILITY NEEDS





**“ By failing to prepare,
we are preparing to fail.”**

– Benjamin Franklin



SCHOOL SECURITY SAFETY PLAN (PHYSICAL SECURITY INTENTIONS)

- » Detect
- » Deter
- » Delay
- » Respond/Investigate
- » Deny (Unauthorized Access)

» SECURITY RISK ASSESSMENT ...



- » Every school is different, has varying conditions, and poses different risks...Security measures must be customized for each school and also consider a change in culture from within;
- » Any risk assessment must focus on “Proactive Prevention through Facility Analysis”.
- » Consider speaking with State DOE & local law enforcement or county representatives for recommendations.
- » Consider speaking with Transportation Security Administration (TSA) for recommendations.

» SECURITY RISK ASSESSMENT ...



- » In assistance with Law Enforcement, Anti-Crime Program Specialists, your district should look to...
- » ...measure each facility against a comprehensive security checklist and
- » ...determine where it excels and where it may be lacking from a technology, hardware and potentially a personnel standpoint.



HOW SAFE ARE OUR BUILDINGS?

- » How can sound design improve the productive use of space – **define, deter, detect and even delay potential violent offenders** and even prevent senseless acts of violence?
- » Good, **sensible design can make a safe building safer** and yet maintain a warm and inviting environment for our children.



KEY AREAS OF VULNERABILITY:

- » Ingress / Egress / School Perimeter
- » Communications – Classroom to Office and School to Police
- » Classroom & Core Space Lock-down ability
- » Decentralized Lock-Down
- » Transportation Operations



INGRESS / EGRESS/ PERIMETER

- » Does the current plan protect every access point?
- » Intrusion Detection
- » Access Control / Detention
- » Video Surveillance



INGRESS / EGRESS/ PERIMETER

» Is there a visitor-management program

- ID required PRIOR to entry
- Secure check-in – Visitor Badging Systems
- No “TAILGATING” permitted
- Escorting visitors whenever possible
- District issued identification to frequent or regular vendors
- Delivery Restrictions – loading dock only policies

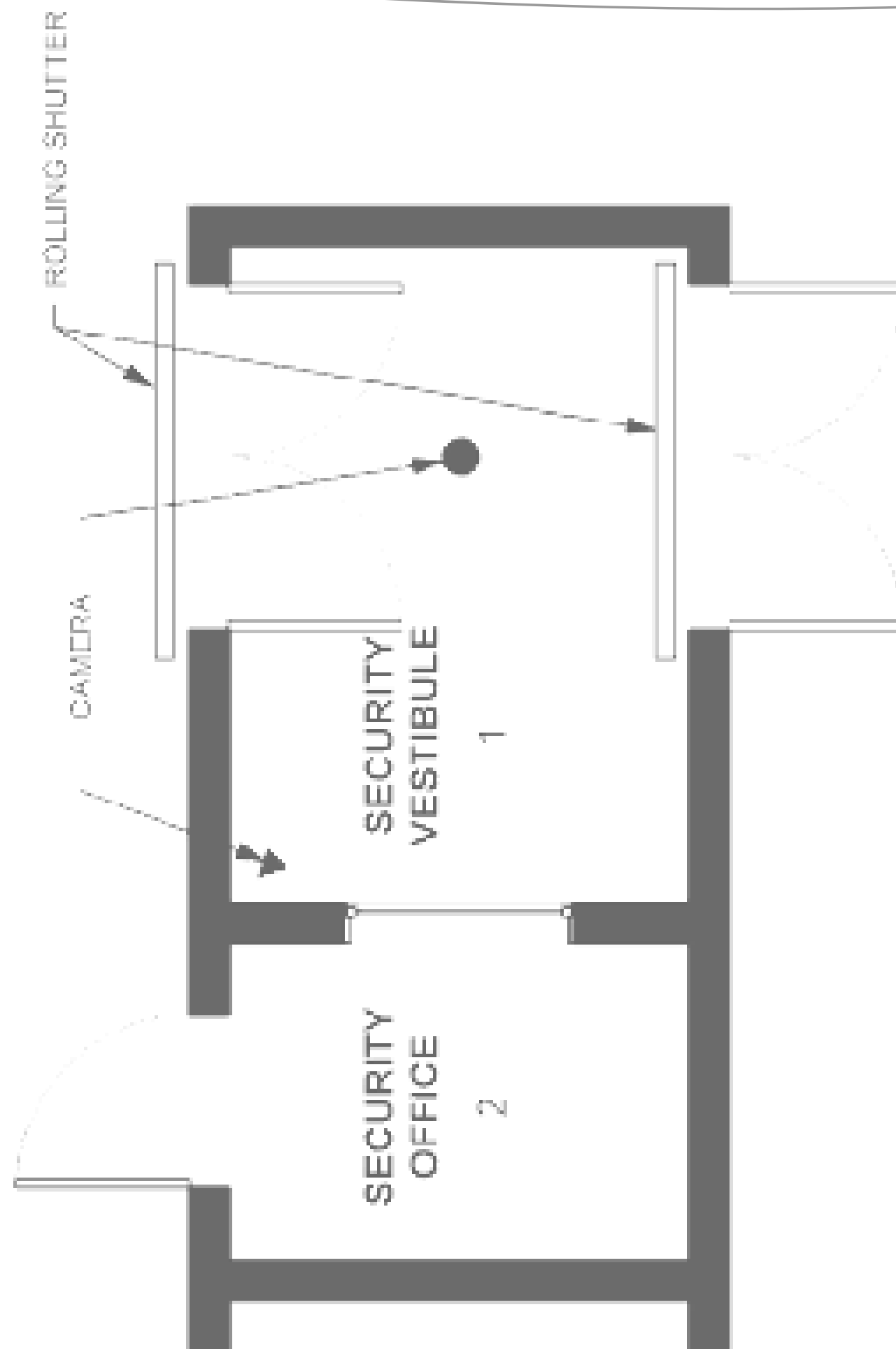

INGRESS / EGRESS/ PERIMETER

- » End of Day Security Check
 - Ensure that Building Perimeter -- all exterior doors and windows are closed and secure
- » Determine what physical changes, if any, need to occur to ensure safe entry and egress
- » Secure Vestibule – “Man Trap”

» SECURE VESTIBULES ...

INGRESS / EGRESS / PERIMETER

**Controlled, Secure,
Entrance Design**

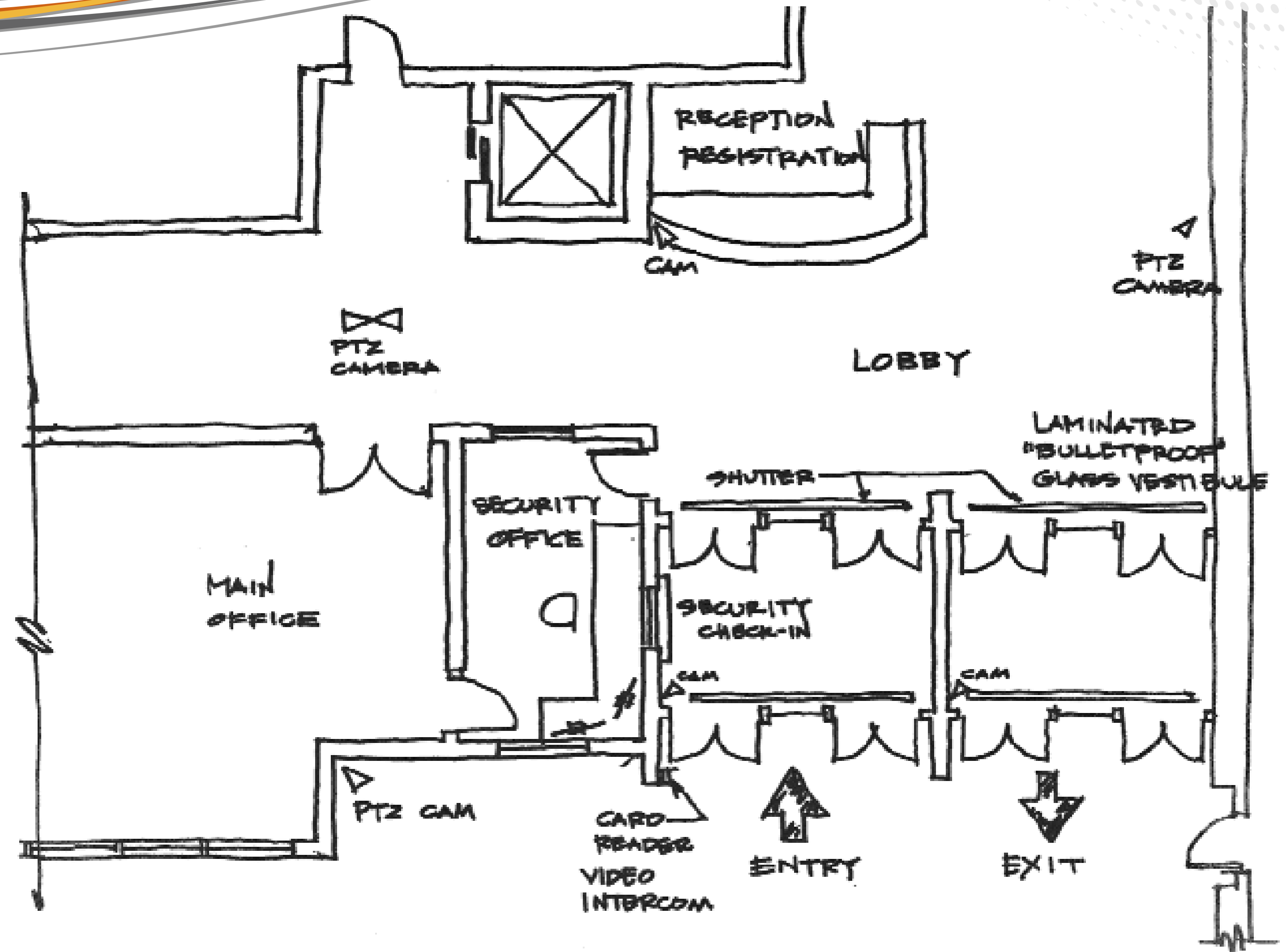



COMMUNICATIONS - CLASSROOM TO OFFICE + SCHOOL TO POLICE

- » Handset/PA in every instructional area & commons -
Panic Buttons
- » Secure and Direct Communications with local authorities by utilizing shared radio frequencies
- » Remote access of school security cameras by police and first responders

» FACILITY VULNERABILITY



SEAMLESS COORDINATION BETWEEN SCHOOL AND LOCAL LAW ENFORCEMENT

- » Familiarity with the school buildings
- » Current facility floor plans on file with fire, police and office of emergency management for use in crisis logistics and planning
- » Recurring police walkthroughs - presence



CLASSROOM & CORE SPACE LOCKDOWN

- » **MUST** be able to lockdown from anywhere in the building
- » **Concept of “Safe Rooms”**
 - Classrooms or Core Spaces (gymnasium, library) that can be retrofit to provide safe haven in the event of targeted school violence
 - Automatic rolling shutters at doors and windows,
 - Crisis Kits, First Aid, Medication, Food
 - Security laminates for glass windows



CULTURAL CHANGES NECESSARY

- » Cannot implement the plan without changing the culture.
- » **MUST** receive “buy-in” from the entire school community.
- » Potential funding assistance
 - www.grants.gov
 - Local law enforcement grants

THE TSA

» » Consider speaking with Transportation Security Administration (TSA) for recommendations.



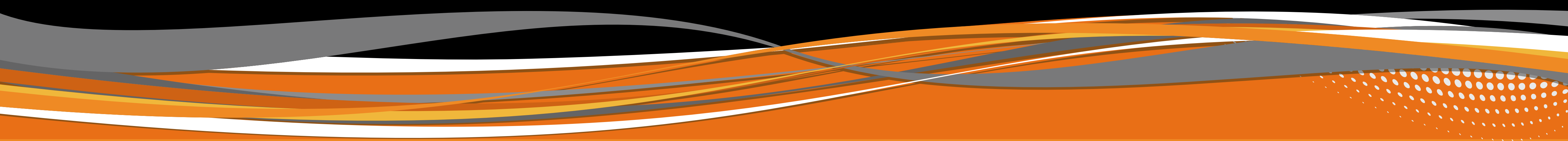

PREVENTION: BEHAVIORAL CONCERNS



» SAFE SCHOOL INITIATIVE (SSI)



United States Secret Service (Secret Service) and the United States Department of Education (ED) embarked on a collaborative endeavor to **study incidents of planned (or targeted) violence in our nation's schools.**

Together they identified specific incidents of targeted school violence and **analyzed the attackers' behavioral pathways**, from the initial idea of the attacks to the violent conclusions.



10 KEY FINDINGS FROM THE SSI

1. Incidents of targeted violence at schools rarely were sudden impulsive acts.
2. Most attackers did not threaten their targets directly prior to advancing the attack.
3. There was no useful or accurate “profile” of students who engaged in targeted school violence.
4. Most attackers had difficulty coping with significant losses or personal failures. Moreover many had considered or attempted suicide.



10 KEY FINDINGS FROM THE SSI *(Continued)*

5. Many attackers felt bullied, persecuted or injured by others prior to the attack.
6. Most attackers had access to and had used weapons prior to the attack.
7. Despite prompt law enforcement responses, most shooting incidents were stopped by means other than law enforcement interventions.



10 KEY FINDINGS FROM THE SSI *(Continued)*

8. In many cases, other students were involved in some capacity.
9. Most attackers engaged in some behavior prior to the incident that caused others concern or indicated a need for help.
10. Prior to the incidents, other people knew about the attacker's idea and/or plan to attack.

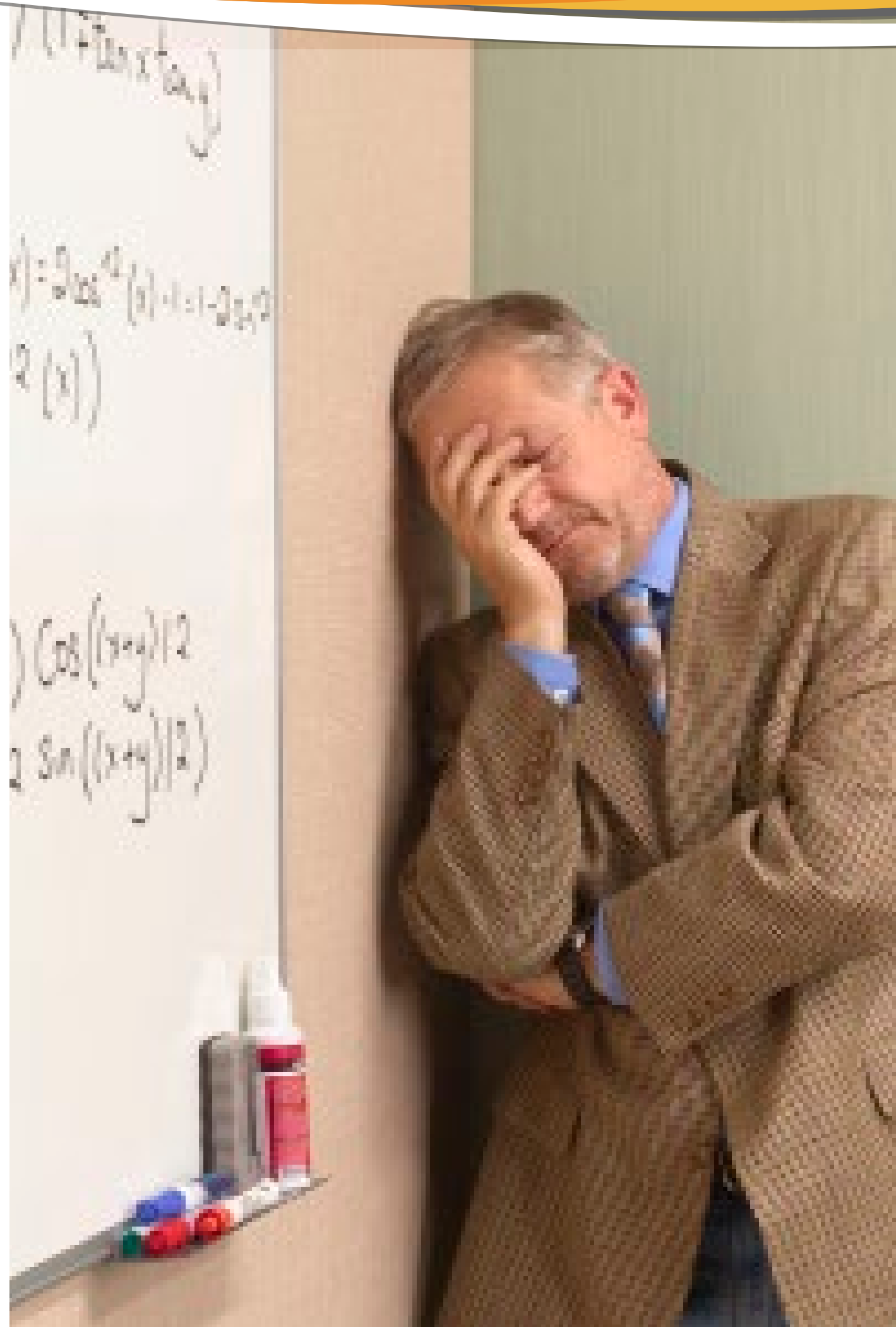

THREAT ASSESSMENT TEAMS

- Combination of faculty, staff, and administrators, including a guidance counselor, mental health professional, and/or school resource officer
- Identify/Assess students / staff who may pose potential threat or who are disengaged in the school population.
(Star Program - know that your students are engaged)

» Potential Attack Indicators

- Observable behaviors that may precede an attack
- Safe School Initiative found that school-based attacks are typically planned in advance

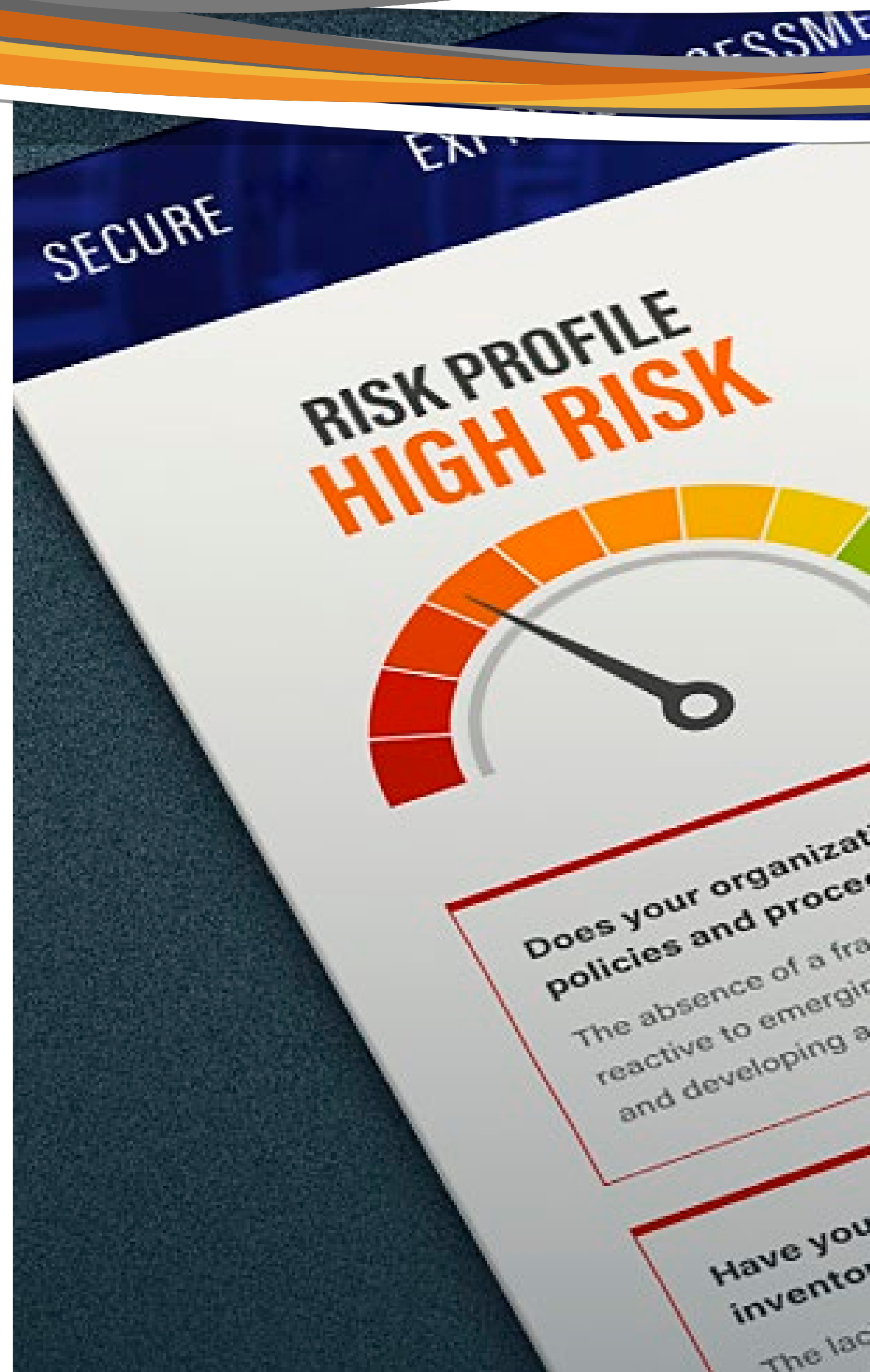

THREAT ASSESSMENT

- » Developing meaningful social and emotional connections with students and creating a climate of mutual respect are essential to keeping schools safe.
- » Students expressed discomfort speaking to anyone, or believed that if they did speak to someone they either **would not be believed or would get into trouble.**
- » One student who knew of a weapon on school property was **reluctant to come forward** because he expected a negative reaction:



EXTINGUISHING THE FEAR OF REPERCUSSION

- » School staff, as well as Law enforcement officials need to convey clearly to students that merely reporting information about potential threats will not subject the student to negative consequences and/or liability.
 - Dedicated email address
- » Provide a place for anonymous reporting within the schools or on the district website where students can report anonymous information
 - 1-800-NUMBER

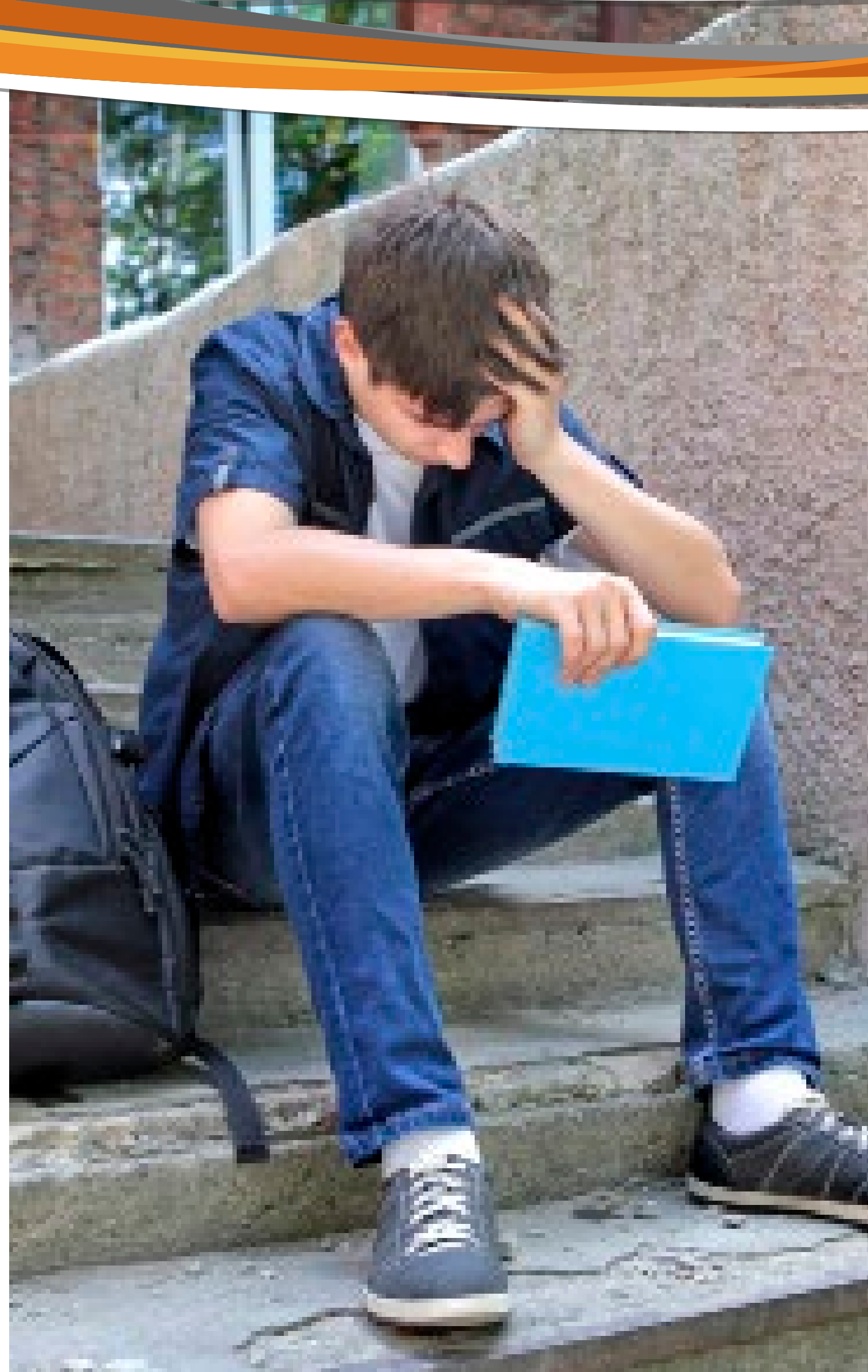

THREAT ASSESSMENT

» Evaluating Troubled Students

- After those students and/or staff who may pose potential threat, have been identified and the appropriate actions taken.
- A key component is requiring psychiatric evaluation clearance to readmit students who have violated safety and security policies before they can return to school

» Long Term Prevention Programs



NEW REQUIREMENTS



» NEW SECURITY REQUIREMENTS



RECENTLY REVIEWED ON APRIL 11, 2018

- » N.J.S.A. 18A:41-1, which requires school districts to hold one fire drill and one security drill per month
- » N.J.S.A. 18A:41-9, which requires schools and law enforcement to enter into agreements for real-time video surveillance, if the schools have such capabilities.
- » N.J.S.A. 18A:7G-5.2, which requires certain school security measures to be incorporated in the architectural design of new school construction and certain school security measures for existing buildings.
- » N.J.S.A. 40A:14-146.10, which establishes Class III Special Law Enforcement Officers to provide security in public/nonpublic schools and county colleges

» NEW SECURITY REQUIREMENTS



RECENTLY REVIEWED ON APRIL 11, 2018

- » N.J.S.A. 18A:41-1: requires school districts to hold one fire drill / one security drill per month
- » N.J.S.A. 18A:41-9, requires schools and law enforcement to enter into agreements for real-time video surveillance, if the schools have such capabilities.
- » N.J.S.A. 18A:58-37.8 et seq. “Secure Schools for All Children Act”; establishes state aid program for security services, equipment, or technology to ensure a safe and secure school environment for nonpublic school students.
- » N.J.S.A. 40A:14-146.10, establishes Class III Special Law Enforcement Officers to provide security in public/nonpublic schools and county colleges

» NEW SECURITY REQUIREMENTS



APPROVED IN DECEMBER OF 2016

- » N.J.S.A. 18A:7G-5.2, which requires certain school security measures to be incorporated in the architectural design of new school construction and certain school security measures for existing buildings. (INTENT ON HARDENING THSE SOFT TARGETS)
- » A Single Public Entrance - Secured Vestibule - Electronic Door Release
- » Lockable (keyless) Interior Hardware for spaces serving as safe havens during lockdowns
- » Access control system with remote unlocking, intercom, fixed cameras
- » Surveillance Cameras
- » Ballistic or shatter resistant film for glass entrance door sidelights or other vulnerable first floor areas.

Please enjoy this information as an insight into the process of school security... For further information on conducting a district-wide security assessment contact:

SOLUTIONS ARCHITECTURE | FRANK MESSINEO, AIA

fm@solutions-arch.com | www.solutions-arch.com

973-484-4800 (OFFICE) | 201-618-0606 (CELL)



» RESOURCES AVAILABLE



NJ SCHOOL SECURITY TASK FORCE REPORT AND RECOMMENDATIONS

» www.state.nj.us/education/schools/security/TaskForceReport.pdf

US DOE & SECRET SERVICE - SAFE SCHOOL INITIATIVE

» www2.ed.gov/admins/lead/safety/preventingattacksreport.pdf

NJ EMERGENCY MANAGEMENT VIRTUAL TOOLKIT

» www.rems.ed.gov/virtual-toolkit/index.html

NJ DOE SCHOOL SAFETY AND SECURITY PLAN CHECKLIST

» www.state.nj.us/education/schools/security/req/checklist.pdf

» REPUTABLE PROGRAMS



GOGUARDIAN - CHROMEBOOK MONITORING & WEB FILTERING

» www.goguardian.com

NJ DOE SECURITY ASSESSMENTS

» <https://homerom5.doe.state.nj.us/security/training/>

LOBBYGUARD - VISITOR MANAGEMENT SOFTWARE

» www.lobbyguard.com

SOCIAL SENTINEL - SOCIAL MEDIA MONITORING/THREAT ASSESSMENT

» www.socialsentinel.com

STOPIT - ANONYMOUS REPORTING & INCIDENT MANAGEMENT

» www.stopitsolutions.com

» REPUTABLE VENDORS

ARMoured ONE - SECURITY FILM AND GLAZING

» www.armouredone.com

3M - SAFETY AND SECURITY FILM

» www.windowfilmdepot.com/3mwindowfilm.html

TOTAL SECURITY SOLUTIONS - BULLET RESISTANT PRODUCTS

» www.tssbulletproof.com

SCHOOL GUARD GLASS - VARIETY OF BULLET RESISTANT GLASS

» www.schoolguardglass.com

»» RESOURCES AVAILABLE



DEPARTMENT OF HOMELAND SECURITY WEBSITE:

» <http://www.dhs.gov/school-safety>

CPTED – CRIME PREVENTION THROUGH ENVIRONMENTAL DESIGN

» <http://www.cpted.net>

NCEF – NATIONAL CLEARINGHOUSE FOR EDUCATIONAL FACILITIES

» <http://www.ncef.org>

» BIBLIOGRAPHY

ACTIVE SHOOTER PREPAREDNESS

» <http://www.dhs.gov/active-shooter-preparedness>

IF YOU SEE SOMETHING, SAY SOMETHING

» <http://www.dhs.gov/if-you-see-something-say-something-campaign>

U.S. SECRET SERVICE NATIONAL THREAT ASSESSMENT CENTER (NTAC)

» <http://www.secretservice.gov/ntac.shtml>

PRIMER TO DESIGN SAFE SCHOOL PROJECTS IN CASE OF TERRORIST ATTACKS & SCHOOL SHOOTINGS

» http://www.dhs.gov/xlibrary/assets/st/bips07_428_schools.pdf

EDUCATIONAL FACILITIES VULNERABILITY/HAZARD ASSESSMENT CHECKLIST

» <http://www.acefacilities.org/Resources/documents/ACEF%20-Vulnerability-Hazard%20Assessment%20Checklist.pdf>

DHS PROTECTIVE SECURITY ADVISORS

» <http://www.dhs.gov/protective-security-advisors>

CRITICAL INFRASTRUCTURE VULNERABILITY ASSESSMENTS

» <http://www.dhs.gov/critical-infrastructure-vulnerability-assessments>

STUDENT REPORTS OF BULLYING AND CYBER-BULLYING: RESULTS FROM THE 2009 SCHOOL CRIME SUPPLEMENT TO THE NATIONAL CRIME VICTIMIZATION SURVEY

» <http://nces.ed.gov/critical-infrastructure-vulnerability-assessments>